

**Shaw  
& Co**  
ESTATE  
AGENTS

**£399,950**

**High Street**

Hounslow, TW3 1AJ

ANYTIME  
FITNESS

TOPAZ  
APARTMENTS

**Shaw & Co**  
ESTATE AGENTS



## PROPERTY SUMMARY

Welcome to this charming property located on High Street in the heart of Hounslow. This delightful flat boasts three cosy bedrooms, perfect for a growing family or those in need of extra space. The property features a modern open plan kitchen/lounge area, ideal for entertaining guests or simply relaxing after a long day.

In addition to the main bathroom, there is also an additional WC for added convenience. The flat is in excellent condition, ensuring a hassle-free move-in process for the new owners.

Situated in a prime High Street location, this property offers easy access to a variety of amenities including shops, restaurants, and public transport links. Whether you're looking for a new family home or a stylish space to call your own, this flat has it all.

3



1



1







# Topaz Apartments, Hounslow

Approximate Gross Internal Area  
990 sq ft - 92 sq m

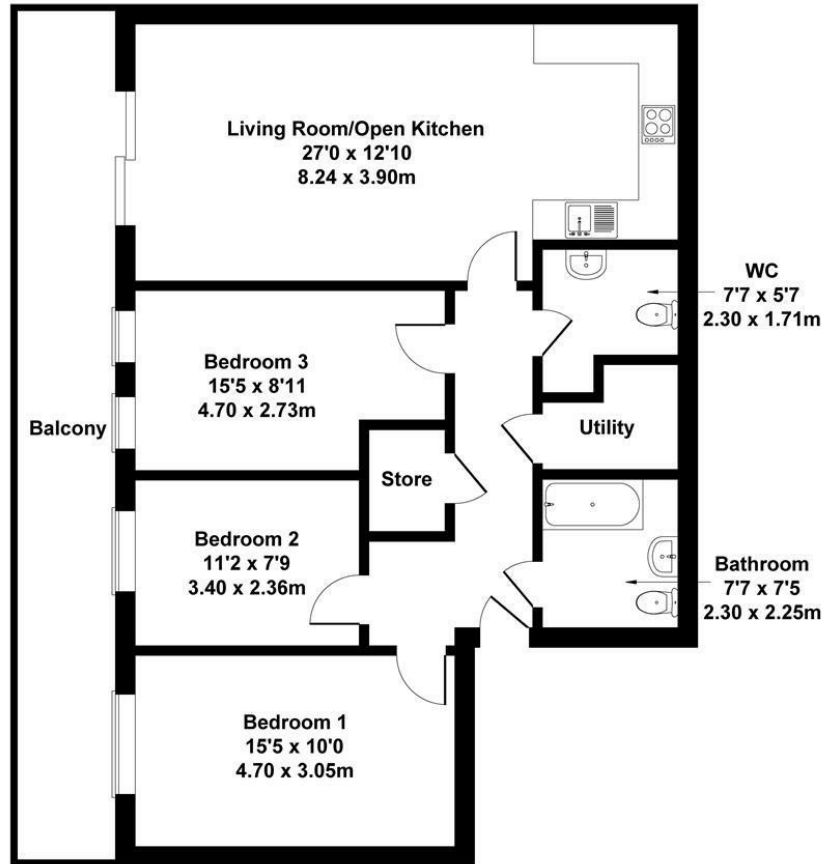

## FIRST FLOOR

Not to Scale. Produced by The Plan Portal 2024  
For Illustrative Purposes Only.

Shaw  
& Co

## LOCAL AUTHORITY

## TENURE

Leasehold

## COUNCIL TAX BAND

## VIEWINGS

By prior appointment only

| Energy Efficiency Rating                    |         |           |
|---|---------|-----------|
|   | Current | Potential |
| Very energy efficient - lower running costs |         |           |
| (92 plus) <b>A</b>                          |         |           |
| (81-91) <b>B</b>                            |         |           |
| (69-80) <b>C</b>                            |         |           |
| (55-68) <b>D</b>                            |         |           |
| (39-54) <b>E</b>                            |         |           |
| (21-38) <b>F</b>                            |         |           |
| (1-20) <b>G</b>                             |         |           |
| Not energy efficient - higher running costs |         |           |
| England & Wales EU Directive 2002/91/EC     |         |           |



Agents Note: Whilst every care has been taken to prepare these particulars, they are for guidance purposes only. All measurements are approximate and are for general guidance purposes only and whilst every care has been taken to ensure their accuracy, they should not be relied upon and potential buyers/tenants are advised to recheck the measurements

**Shaw  
& Co**  
ESTATE  
AGENTS

**OFFICE ADDRESS**  
10 Central Parade  
New Heston Road  
Heston  
Middlesex  
TW5 0LJ

**OFFICE DETAILS**  
0208 570 7258  
heston@shawandcoestates.com